



Out Of Box iPad Setup Guide

Prepared by Berwick College - IT Department

Step by Step guide on how to setup your iPad straight out of the box

Version 1.0

iPad Setup

1. Swipe left to right to begin.

iPad

34% 

Hello

> slide to set up

2. Tap on the “Australian English” option.

iPad

34% 

- Australian English >
- English >
- Français >
- Deutsch >
- 日本語 >
- Nederlands >
- Italiano >
- Español >
- Português >
- Português (Portugal) >
- Dansk >
- Suomi >
- Norsk (bokmål) >
- Svenska >
- 한국어 >
- 한국어 >

3. Tap on the “Australia” option.

iPad

34% 

[← Back](#)

Select Your Country or Region

Australia >

MORE COUNTRIES AND REGIONS

Afghanistan >

Åland Islands >

Albania >

Algeria >

American Samoa >

Andorra >

Angola >

Antigua and Barbuda >

Argentina >

Armenia >

Aruba >

4. This screen presents you with two methods of activating your iPad. You can either connect to a Wi-Fi Network to activate or alternatively you can connect directly to an internet enabled computer with the data/charger cable that comes with your iPad. For the purpose of this guide a Wi-Fi Network will be chosen.

iPad 33% 
[← Back](#)

Choose a Wi-Fi Network

BerwickSC-BYOD	 >
eduSTAR	 >
Optus E586 b0ee	 >

[Choose another network](#)

[Connect to iTunes](#)

Set up your iPad using iTunes if your Wi-Fi network is not available.

5. Enter the password for your Wi-Fi Network.

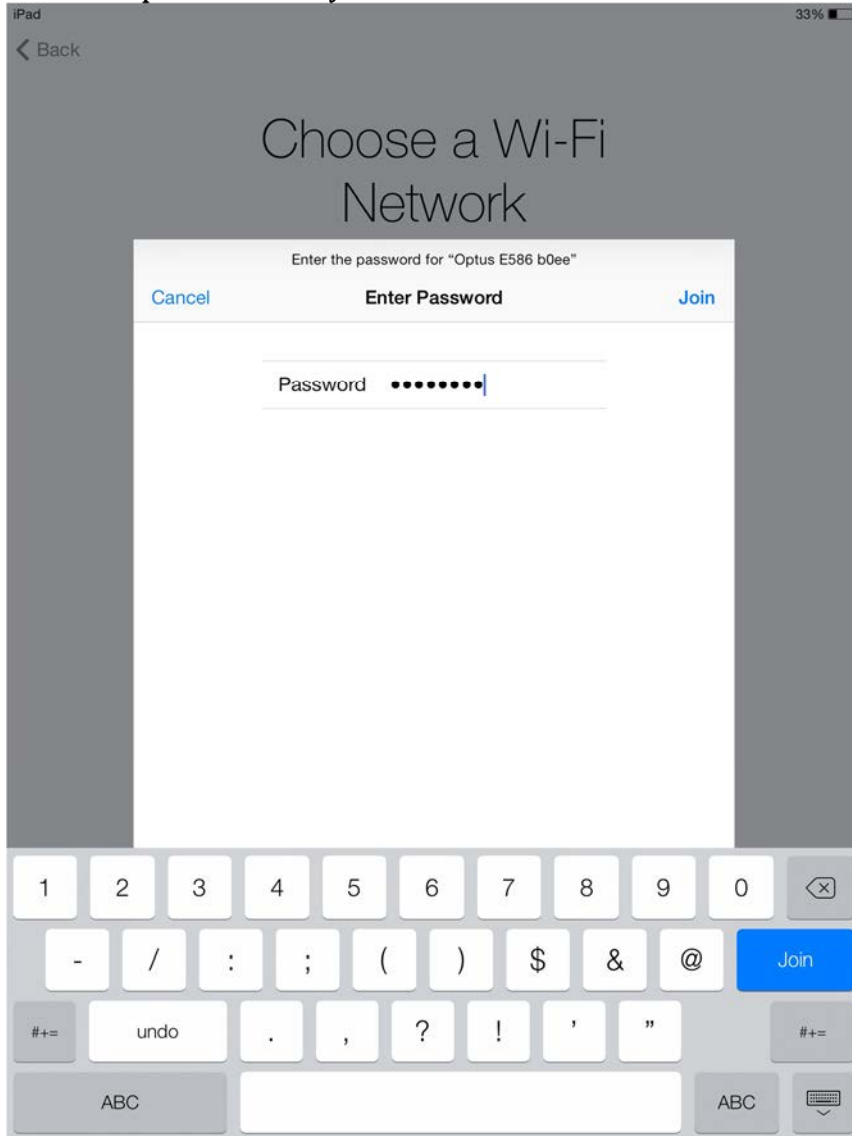

6. The iPad will now activate.

iPad 

7:59 pm

33% 

[← Back](#)



It may take a few minutes to activate your iPad.

7. Tap on the “Enable Location Services” option.

iPad

7:59 pm

33%

[← Back](#)

Location Services

Enable Location Services >

Disable Location Services >



What is Location Services?

Location Services allows Maps and other apps to gather and use data indicating your approximate location.

[About Location Services](#)

8. Tap on the “Set Up as New iPad” option.

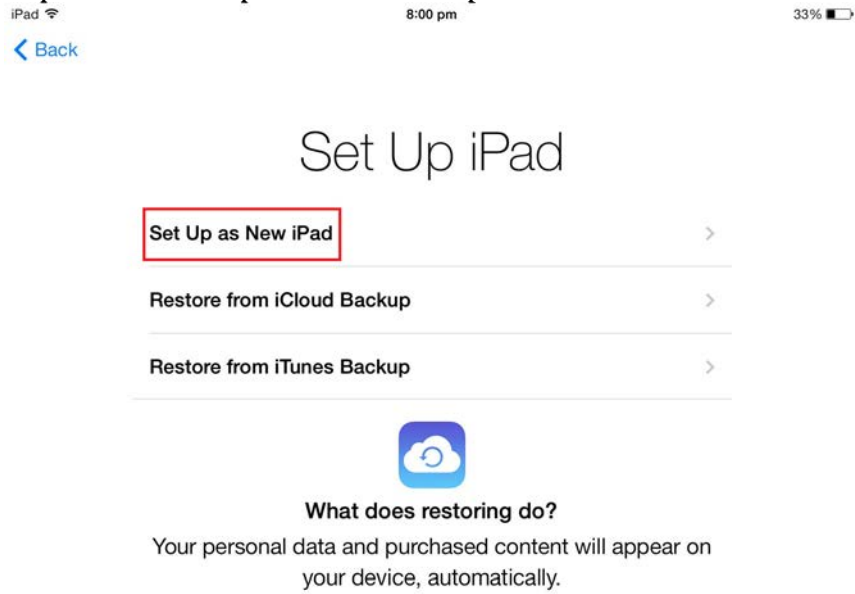

9. Tap on the “Skip This Step” option. (Refer to “Create Apple Account Guide) to create an Apple ID without adding a credit card.



10. Tap on the “Skip” option.

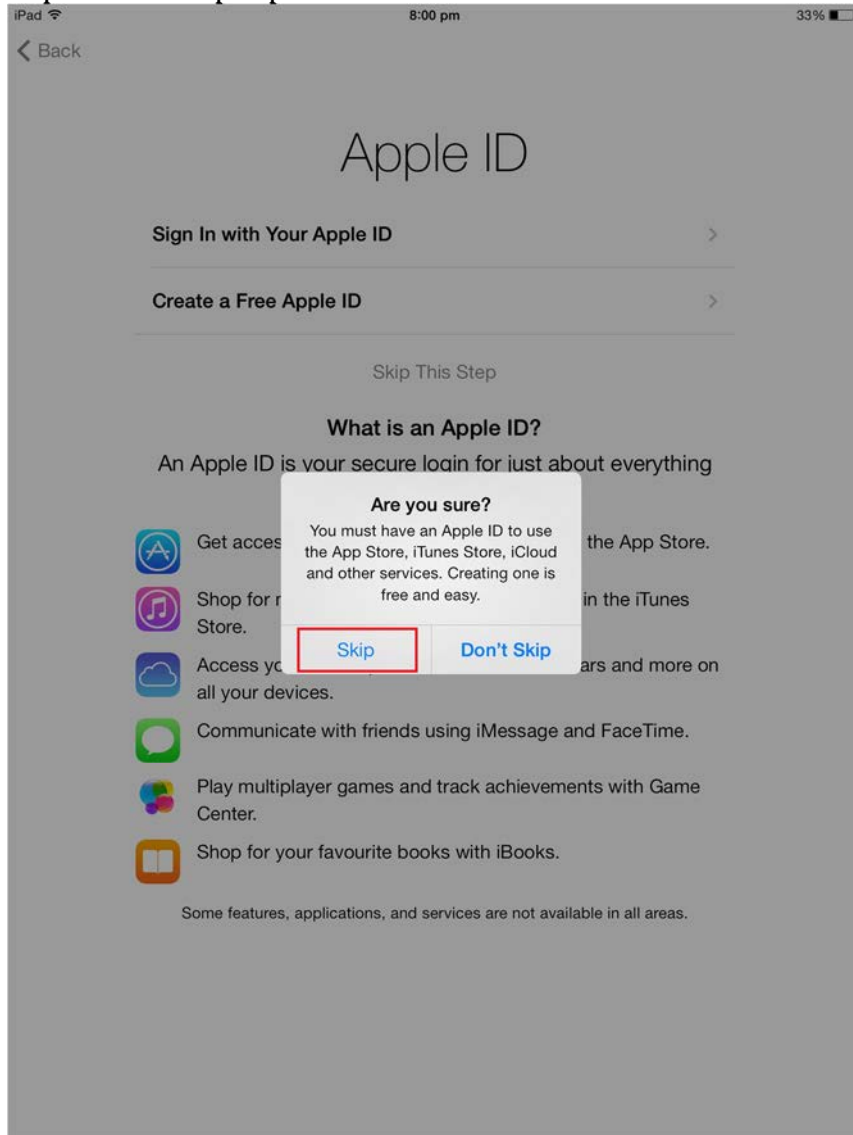

11. Read the Terms and Conditions and if you accept them tap on the “Agree” option.

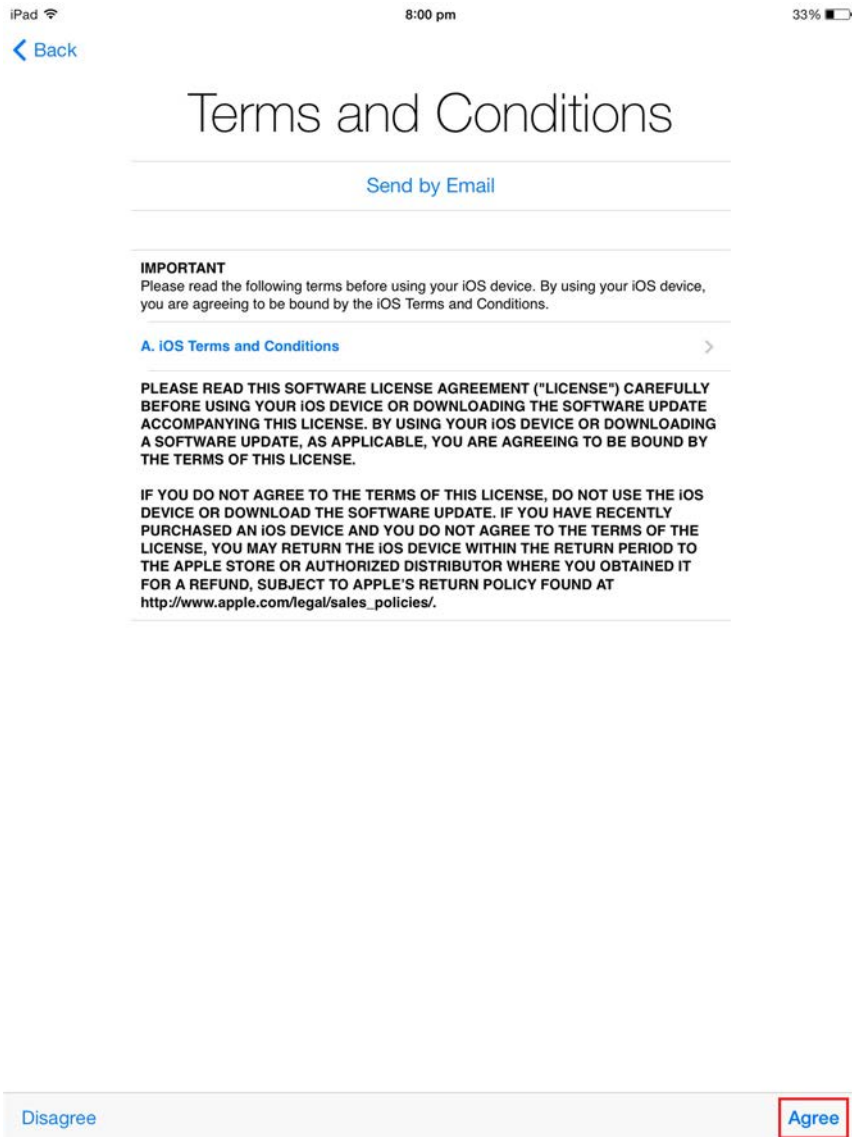

13. You can choose whether to add a passcode to your device or not. For the purpose of this guide “Don’t Add Passcode” will be chosen. If you have chosen to add a passcode skip to step 15.

iPad

8:00 pm

33%

Create a Passcode

Enter a four-digit passcode.

— — — —

Don't Add Passcode



14. Tap and hold on the “Energy Production Research.docx” document.

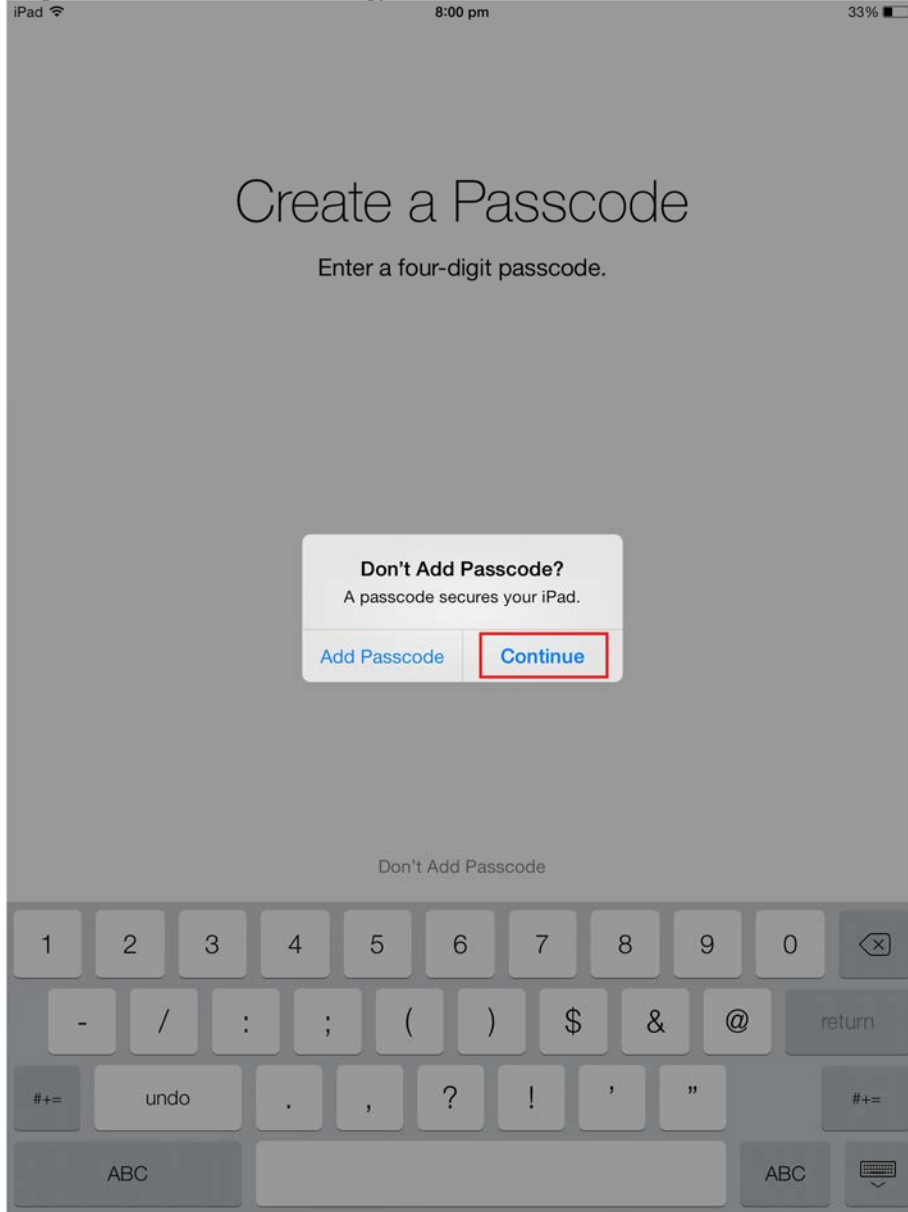

15. You can choose whether or not you want to use Apple's voice assistance software called Siri.

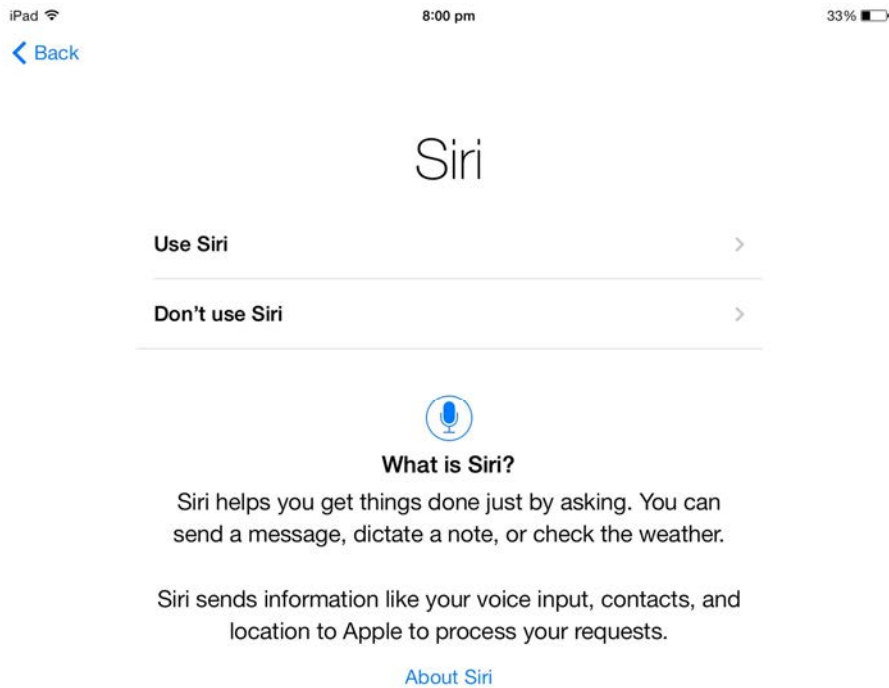

16. Choose whether you wish to assist Apple with Diagnostics or not.

iPad

8:00 pm

33%

[← Back](#)

Diagnostics

Automatically Send >

Don't Send >



Diagnostics & Usage

Help Apple improve its products and services by automatically sending diagnostic and usage data.

Diagnostic data may include location.

[About Diagnostics and Privacy](#)



17. Tap “Get Started” to begin the BSC Enrollment process for your iPad.

iPad

8:01 pm

33%

Welcome to iPad

Get Started